

Assembly Instruction Manual

X O O T

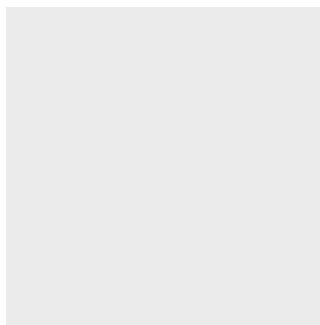

Register your XOOT_Pro for
Warranty or Recall Notification.

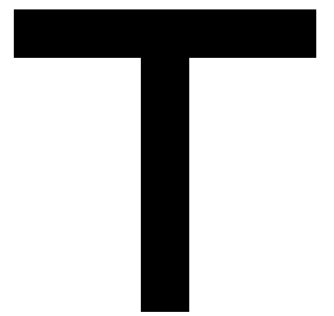
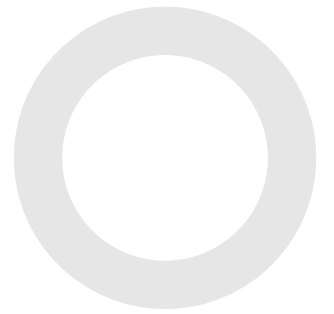

Assembly Instruction Manual

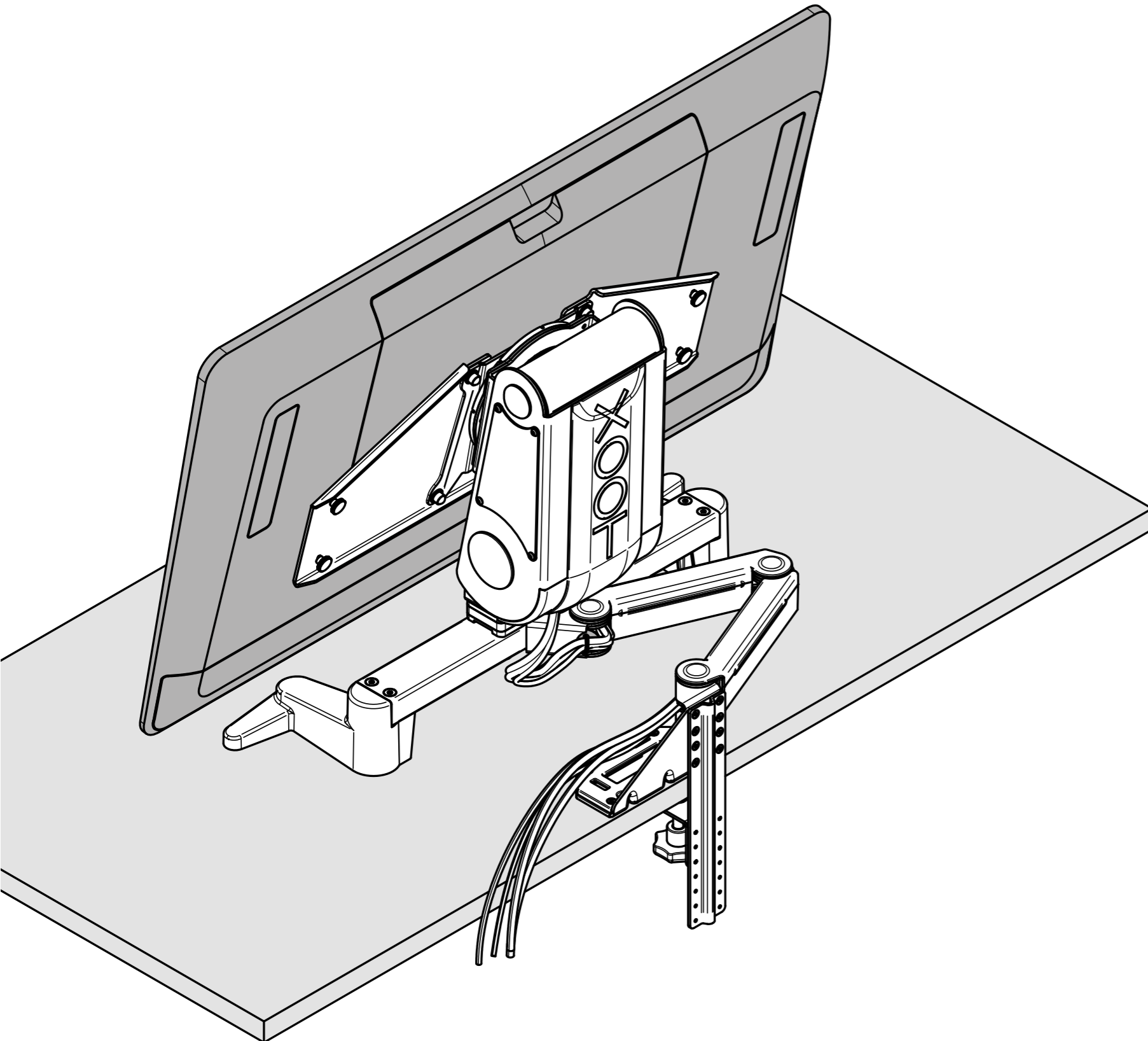

Congratulations as the new owner of a XOOT_Pro

This manual is a visual aid to assembling your XOOT_Pro kit. **Each section has a QR code for linking you to the relevant YouTube videos for each stage of assembly.**

Happy assembling!

	Page
A What's in the Box	2
B Using a Suitable Work Surface	3
C Taking the Main Arm Out of the Box	4
D Assembling the Clamp	6
E Attaching the Legs to the Main Arm	7
F Attaching the Legs to the Clamp	9
G Attaching the Screen to your XOOT_Pro	10
H Stowing Cables and Attaching Covers	13
I Attaching the Touch Strips to your Screen	15
J Adjusting the Rotation Friction	16
K Attaching the Folding Feet to Screen <i>(Optional)</i>	18
L Attaching the Screen to an MT11 or CP27 Kit	20
M Attaching Pre-Stress Pads to an MT11 Kit <i>(Optional)</i>	22
N Attaching Weights to MT11 Kit <i>(Optional)</i>	23
O XOOT Warranty	24
P XOOT Returns	25

A What's in the Box

- | | |
|-------------------------|---------------------------|
| 1 XOOT Arm | 6 Front Cover |
| 2 Clamp | 7 Back Cover |
| 3 Legs | 8 Touch Strips |
| 4 Arm Spacer | 9 Power Supply |
| 5 Misc. Supplies | 10 Rotation Wrench |

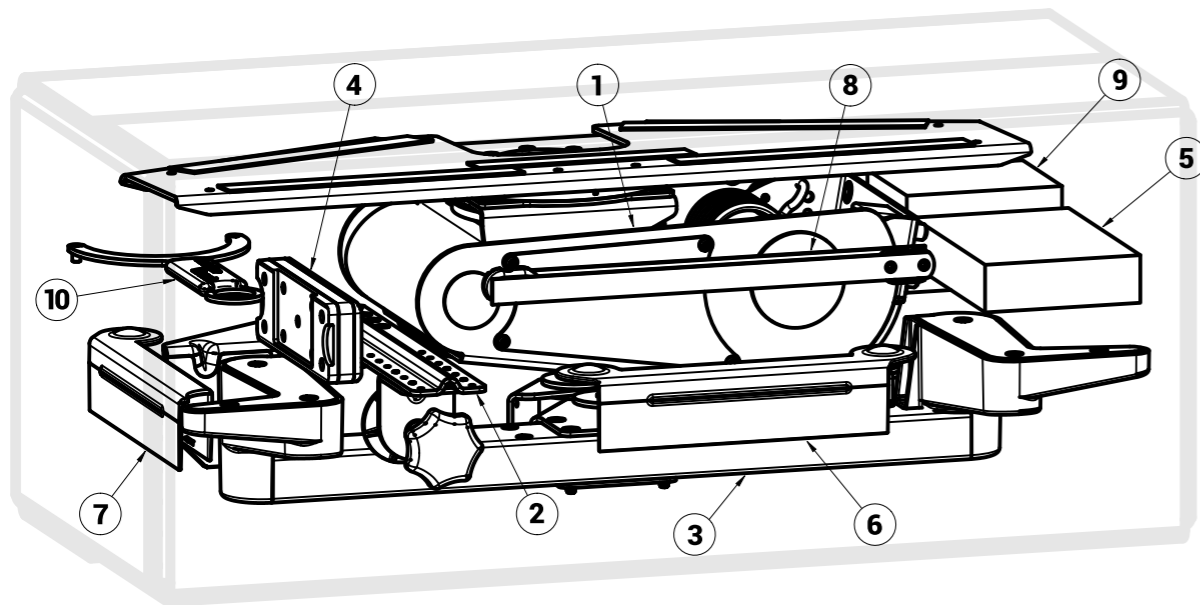

Why the box is packed this way?

We have designed and tested our packaging to be both sturdy and compact. All XOOT_Pro Kit types are accommodated by this single package design, which utilizes fewer materials and reduces shipping and storage costs.

Although the initial set-up might be slightly more complicated, our packaging guarantees that your XOOT_Pro Kit will arrive safely and securely."

B Using a Suitable Work Surface

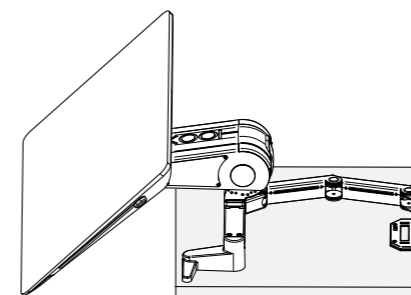
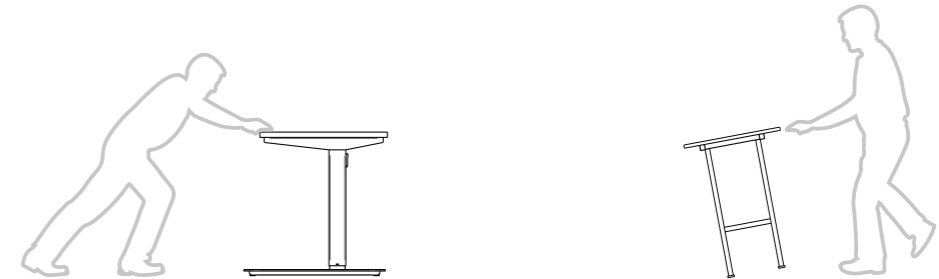
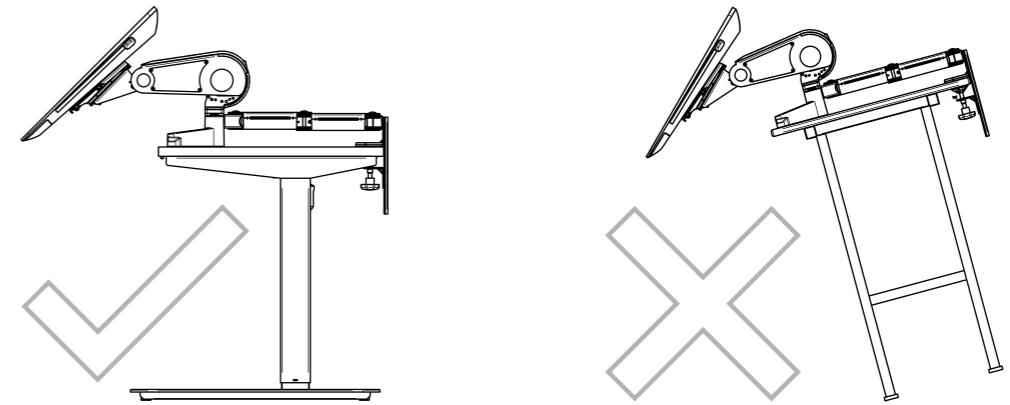

Minimum depth
600mm / 23.5in

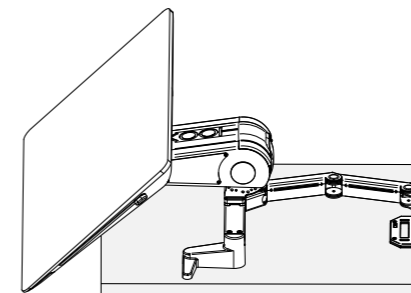

Maximum depth
820mm / 32in

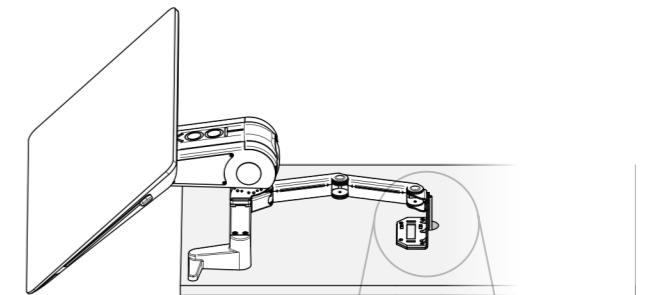

For desks with more depth

Drilling a hole will allow the clamp to fit through and be secured to the work surface. A hole with a minimum diameter of 50mm / 2.0in is required.



C Taking the Main Arm Out of the Box

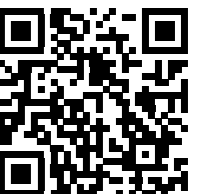
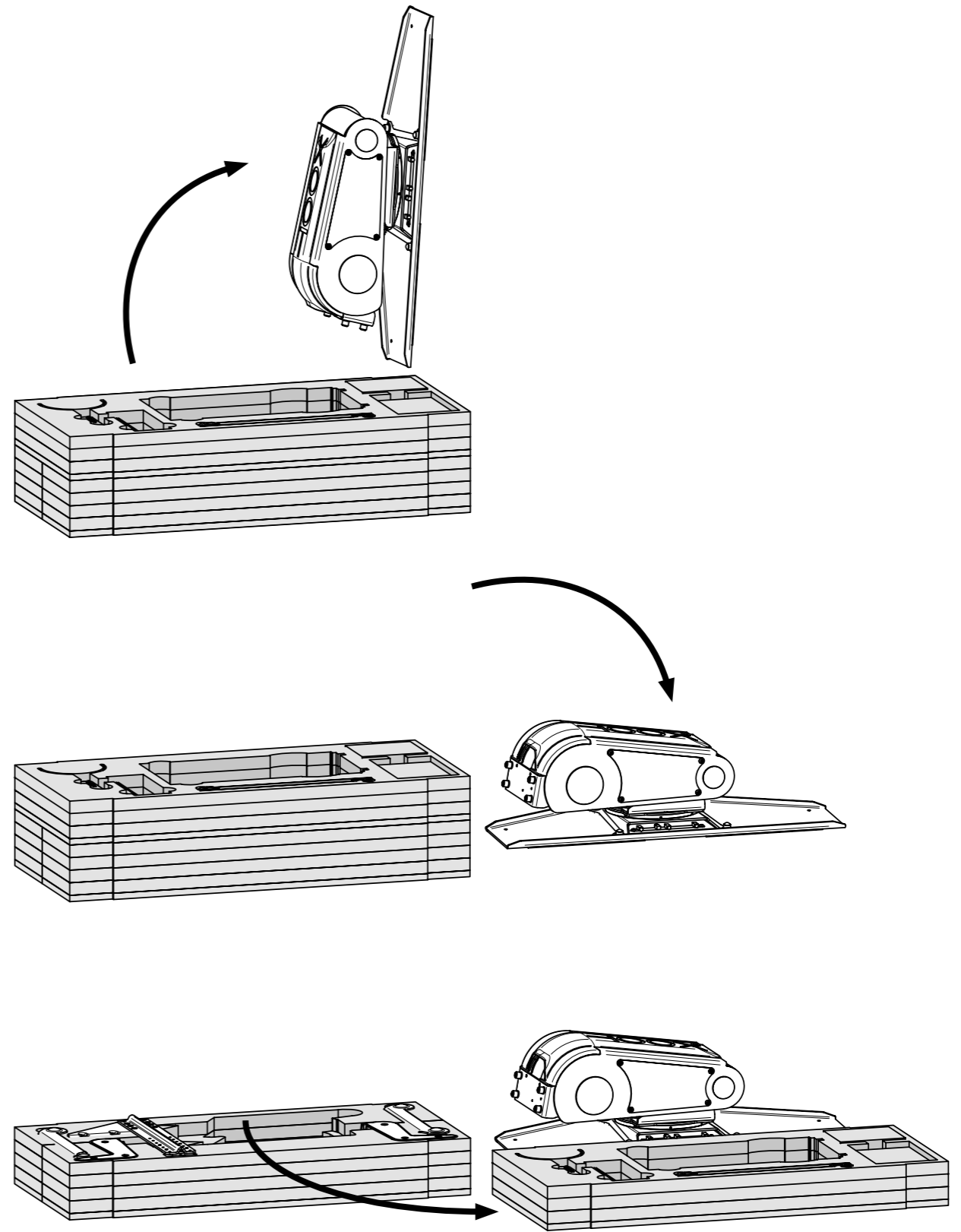
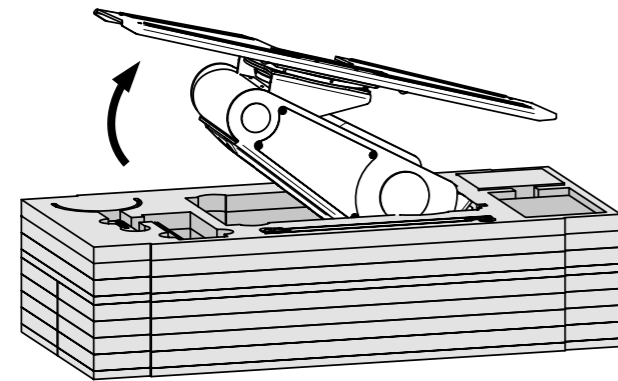
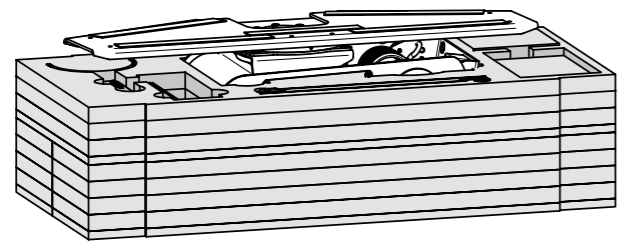
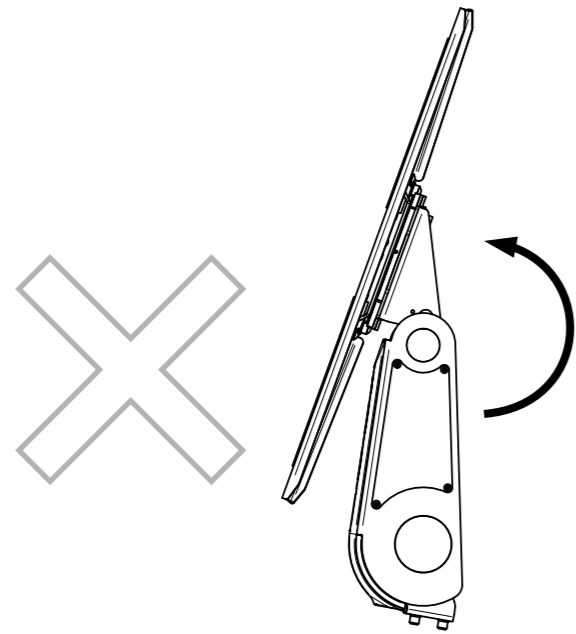

D Assembling the Clamp

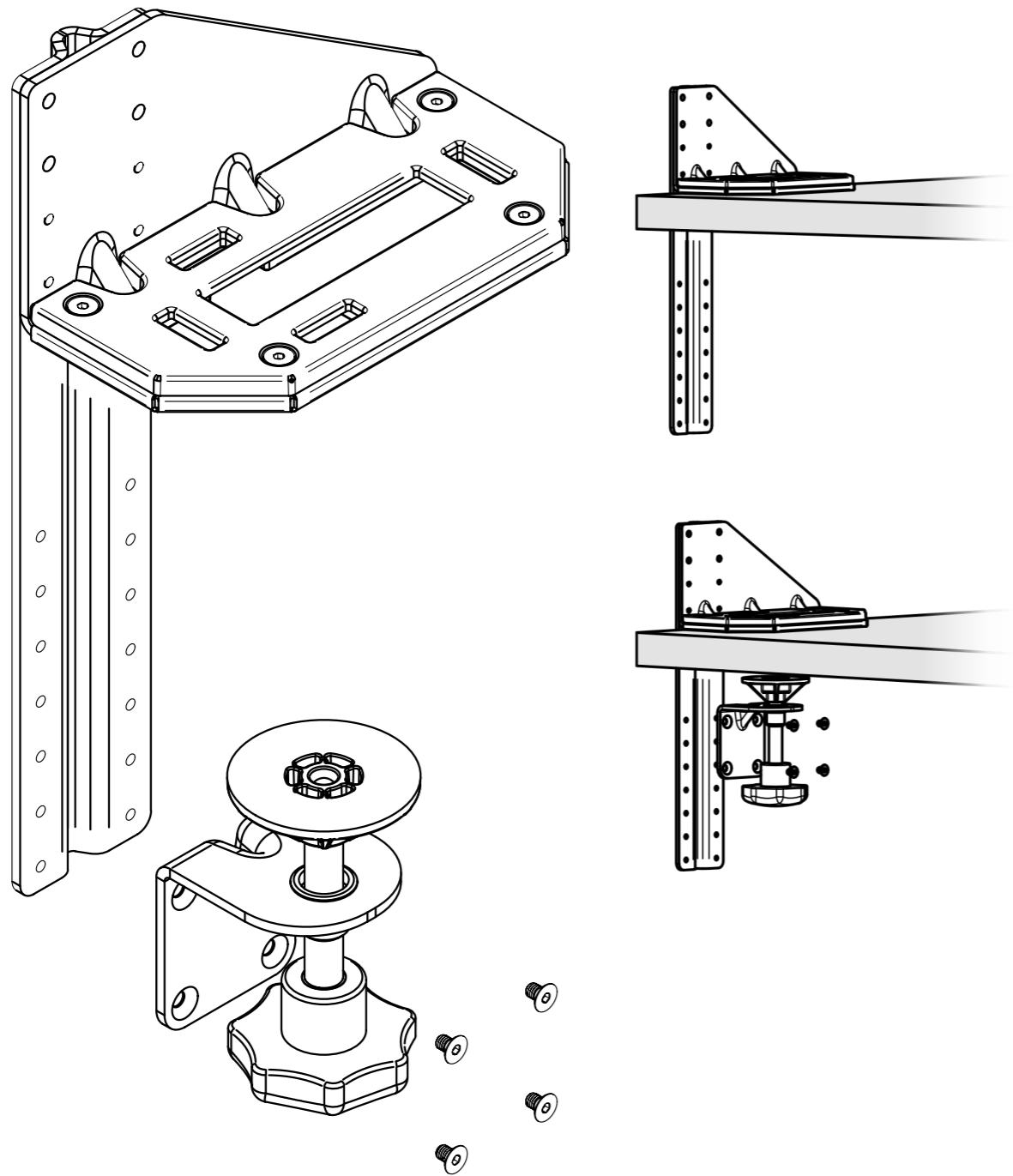

E Attaching the Legs to the Main Arm

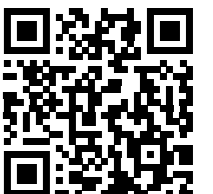
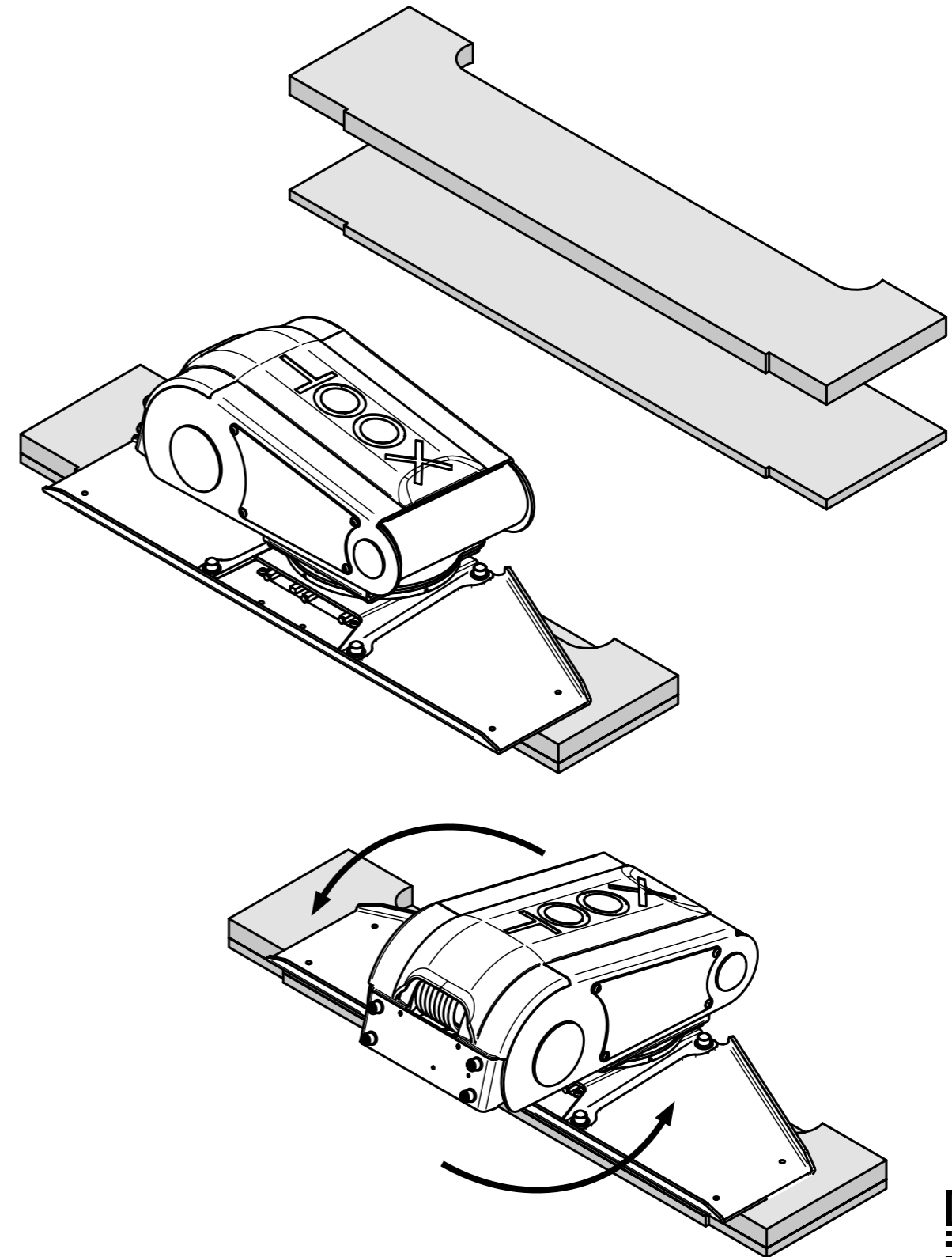

E Attaching the Legs to the Main Arm

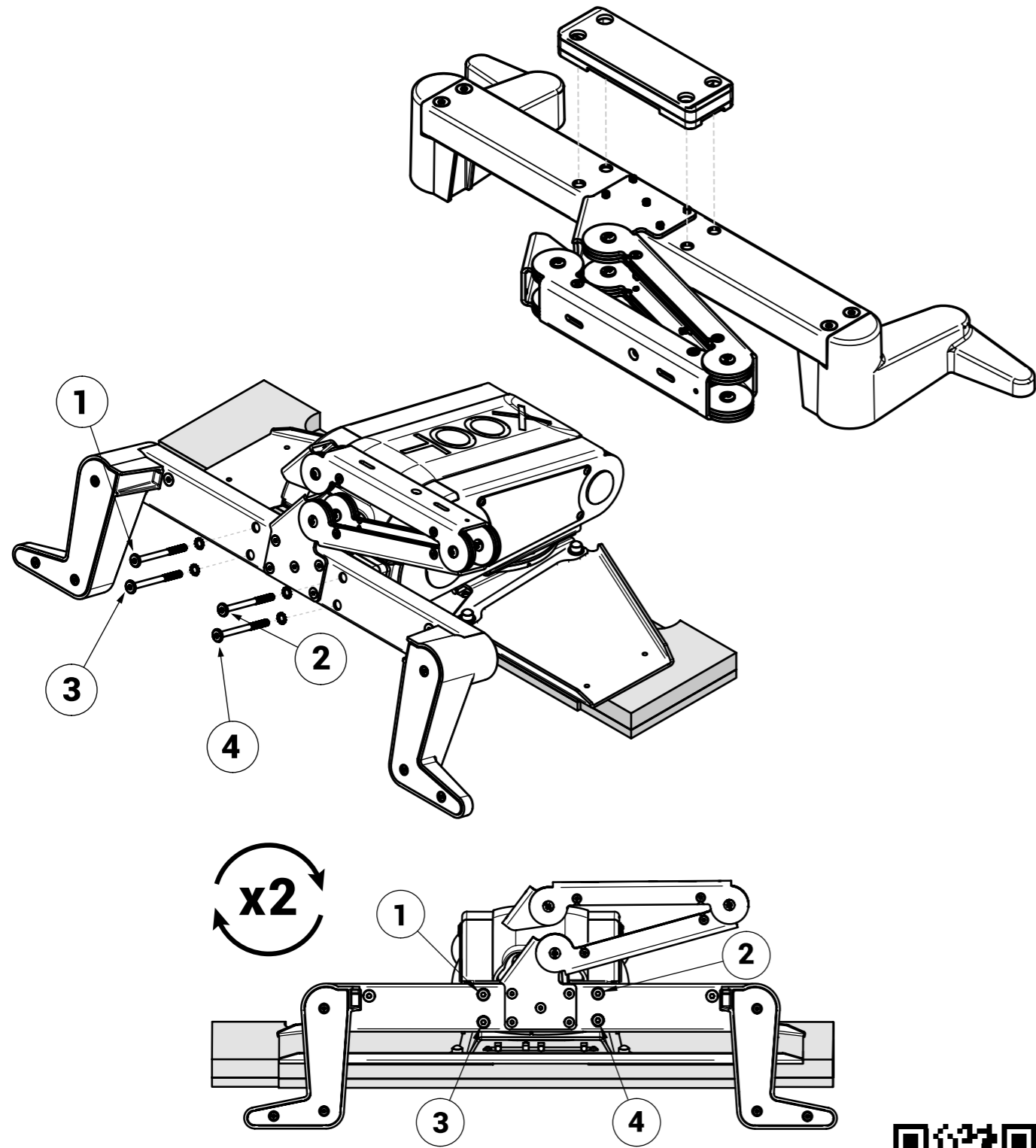

Tighten Bolts a Second Time



F Attaching the Legs to the Clamp

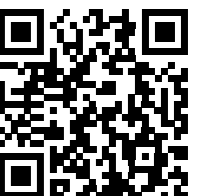
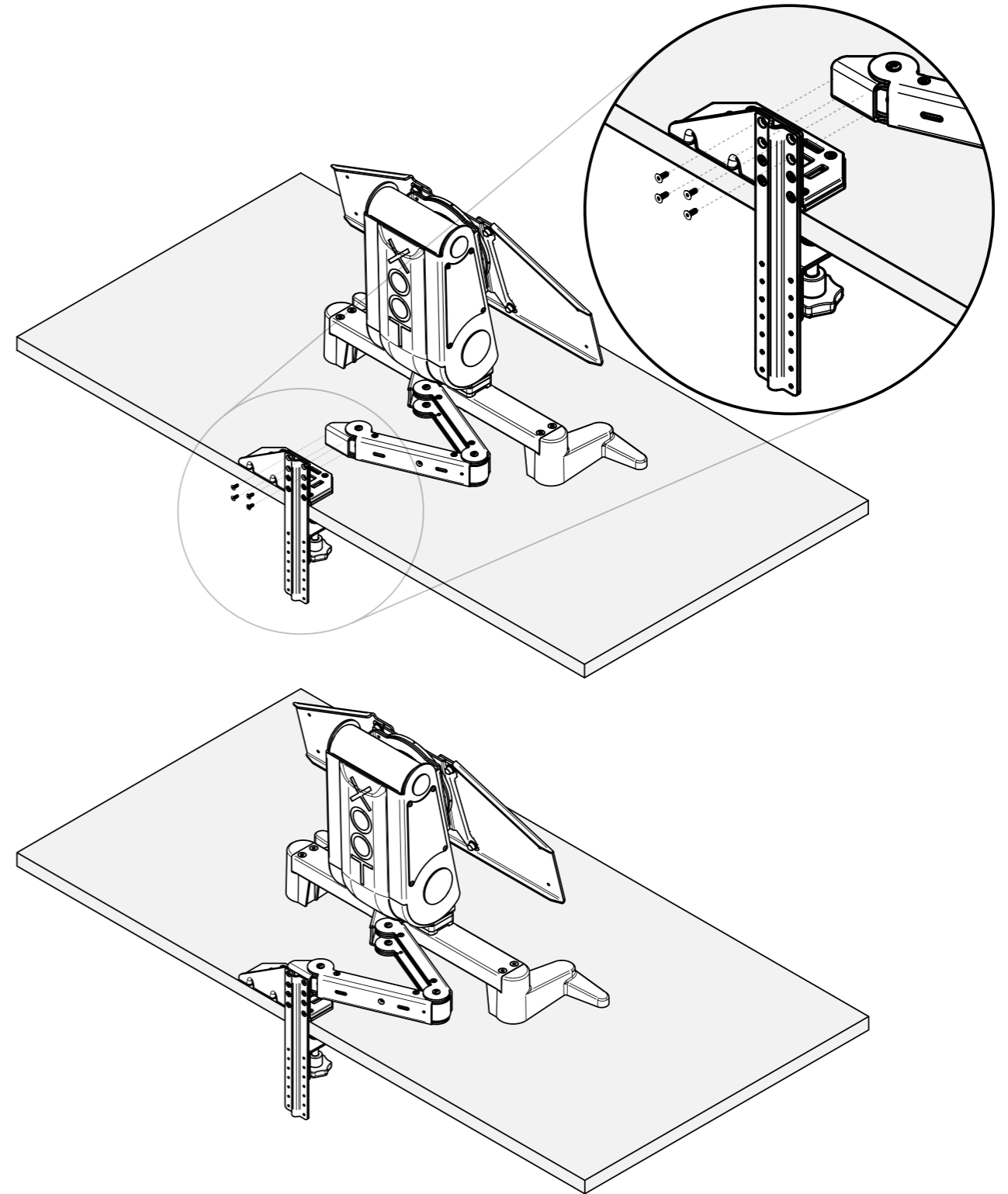

G Attaching the Screen to Your XOOT System

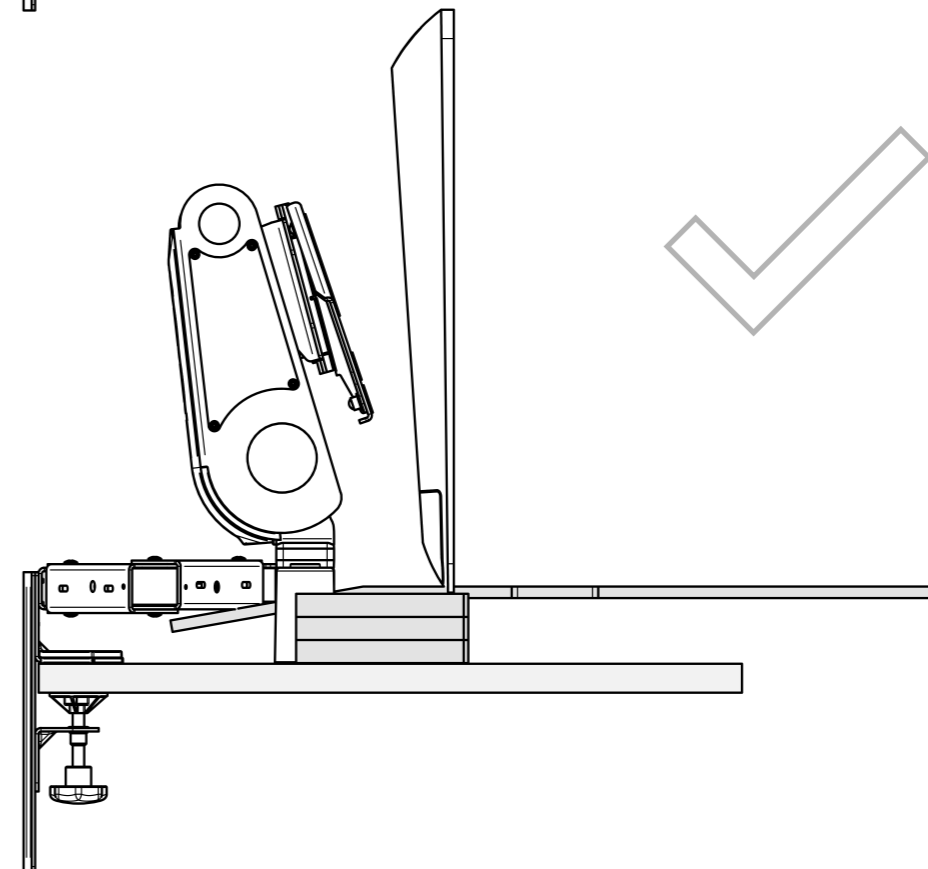
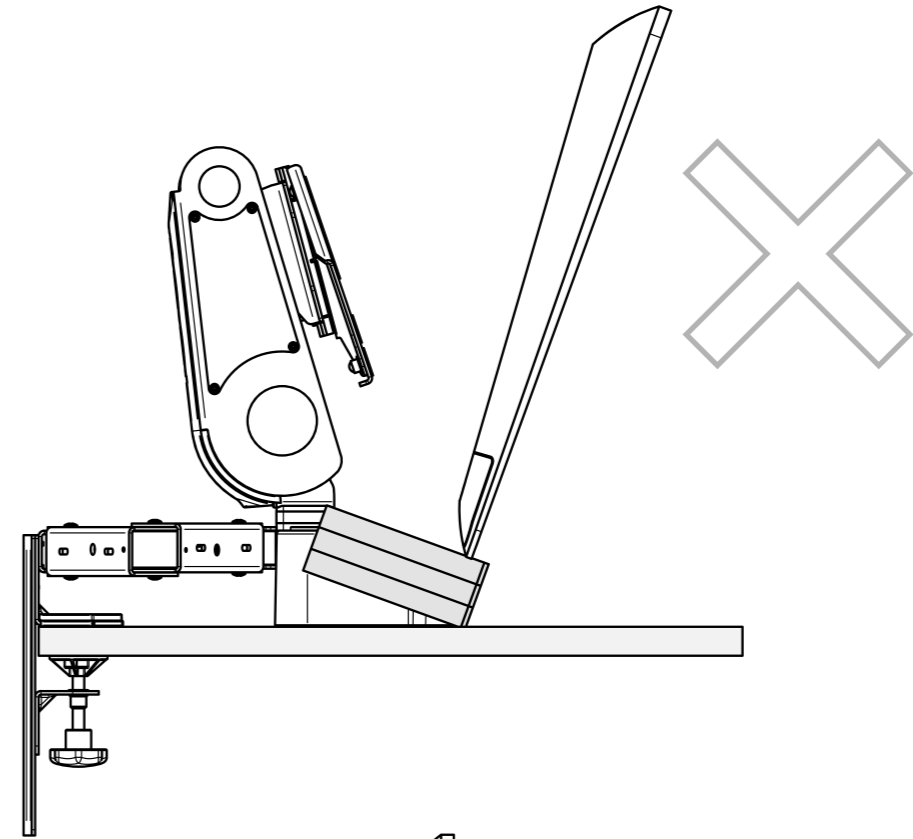
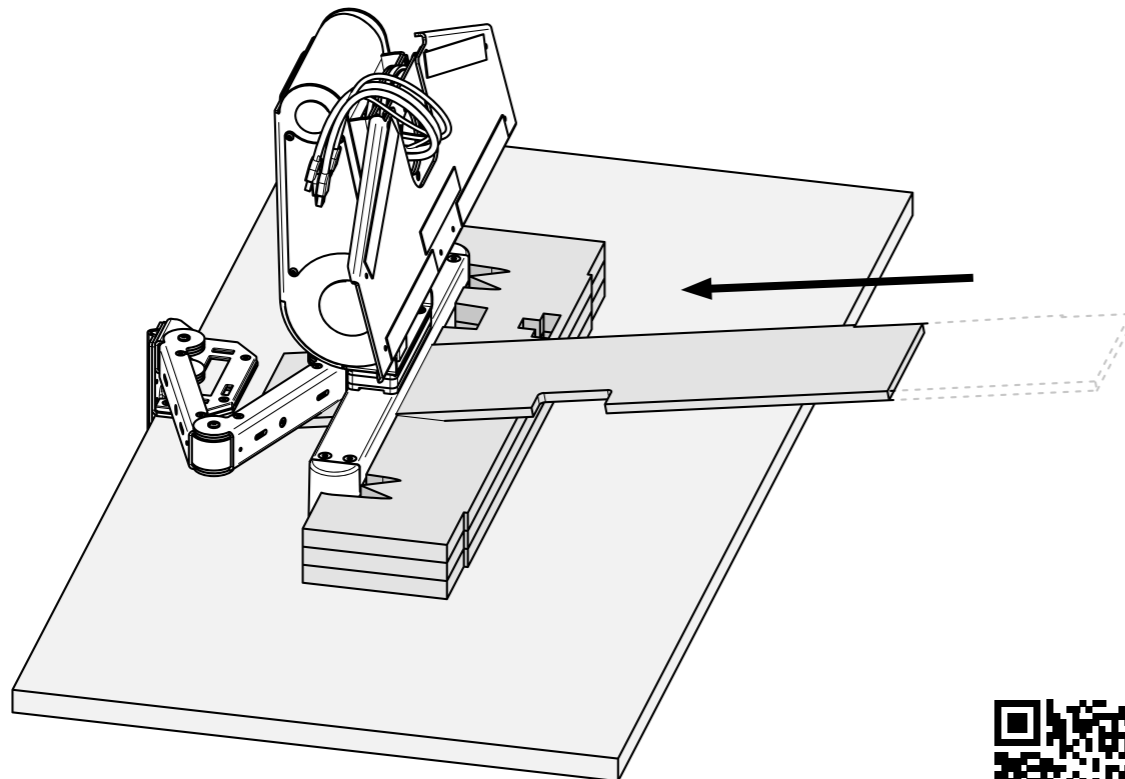
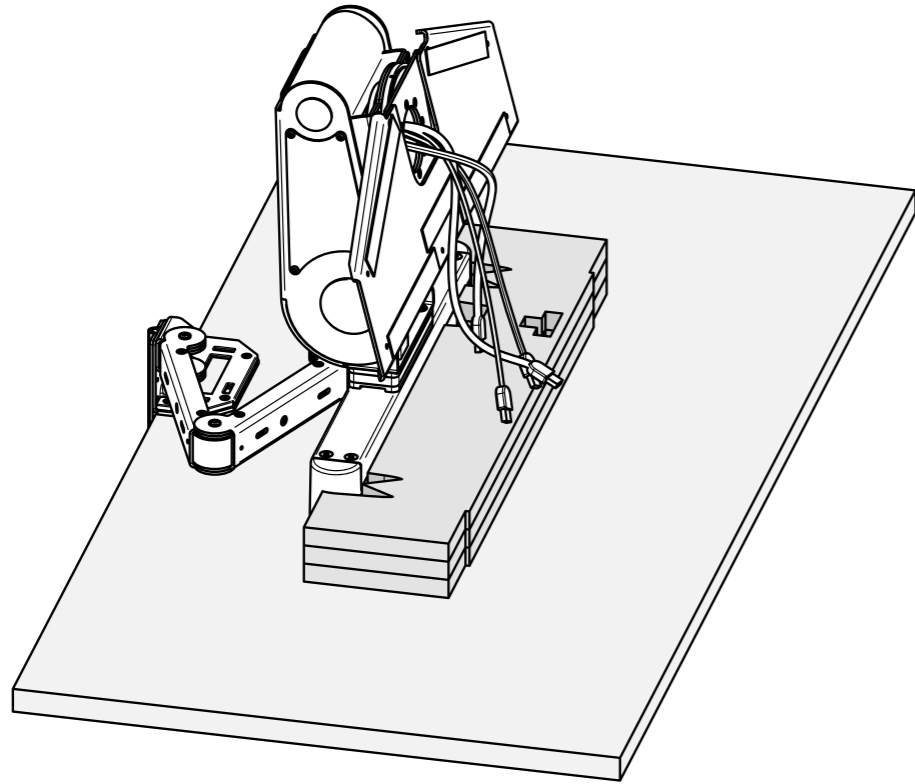

G Attaching the Screen to Your XOOT_Pro

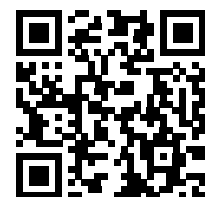
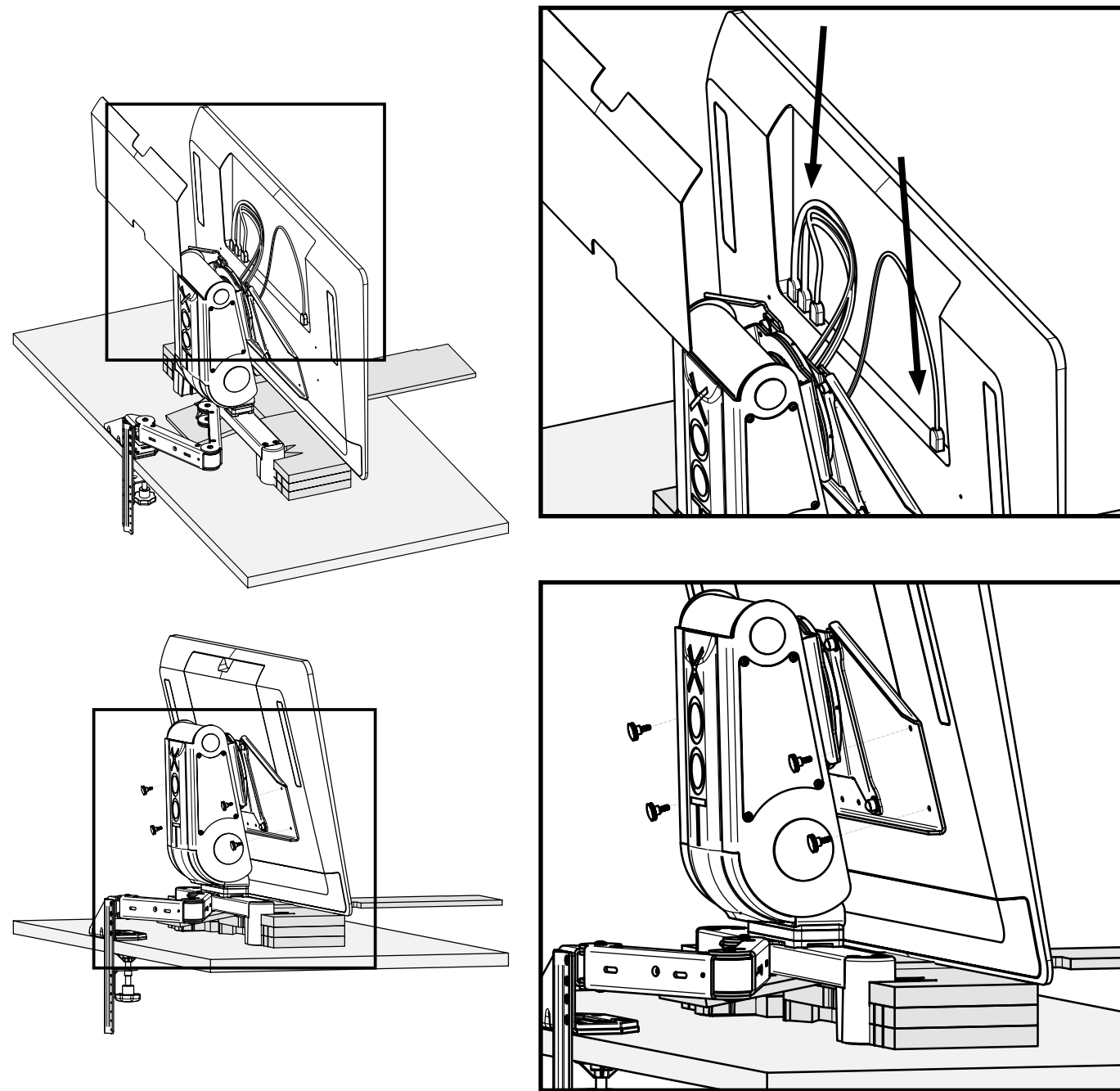

H Stowing Cables and Attaching Covers

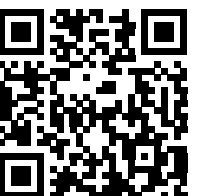
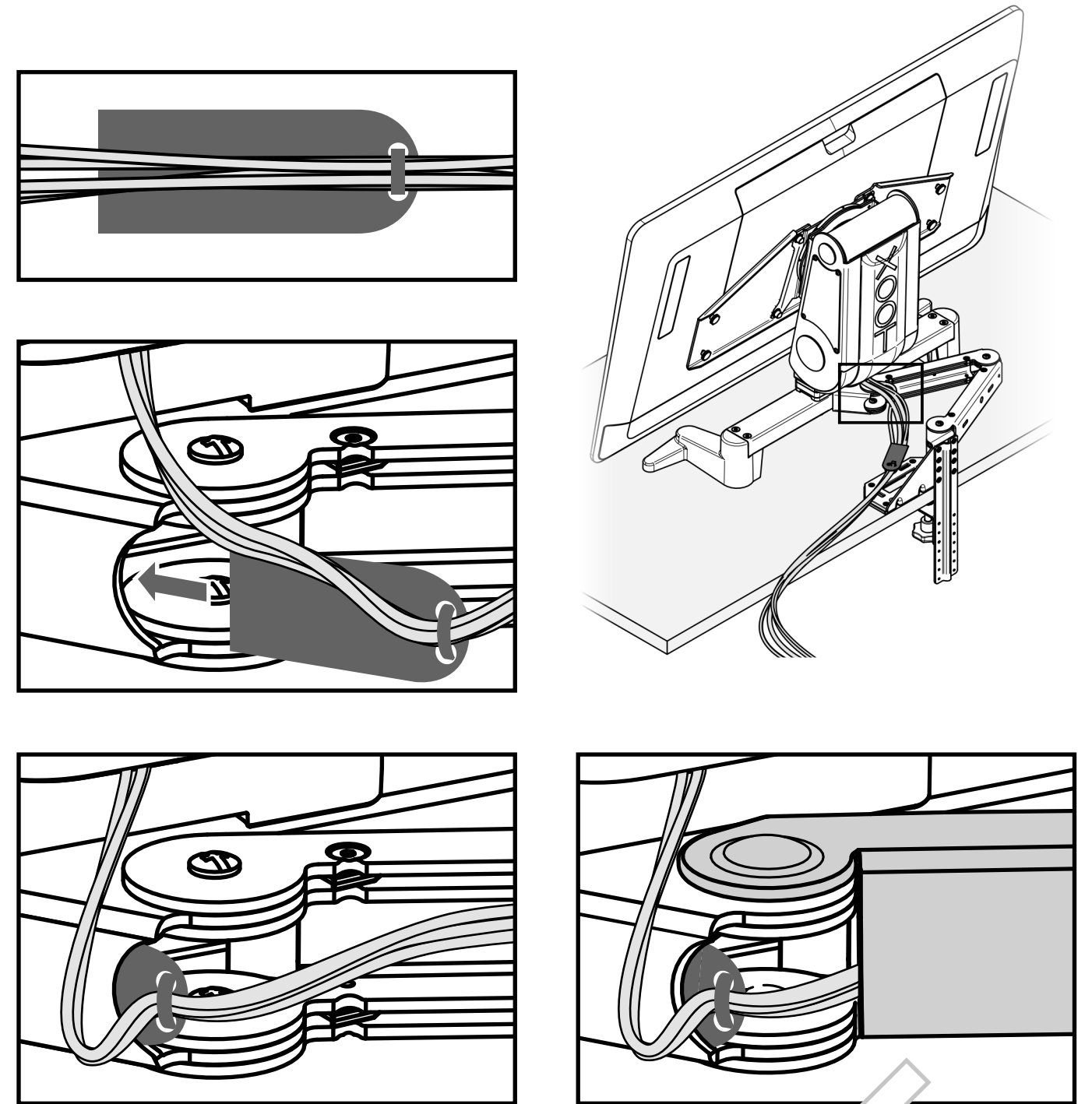

H Stowing Cables and Attaching Covers

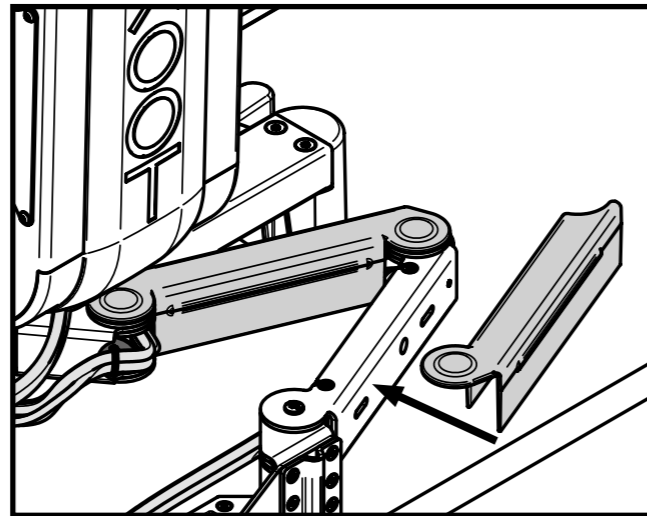
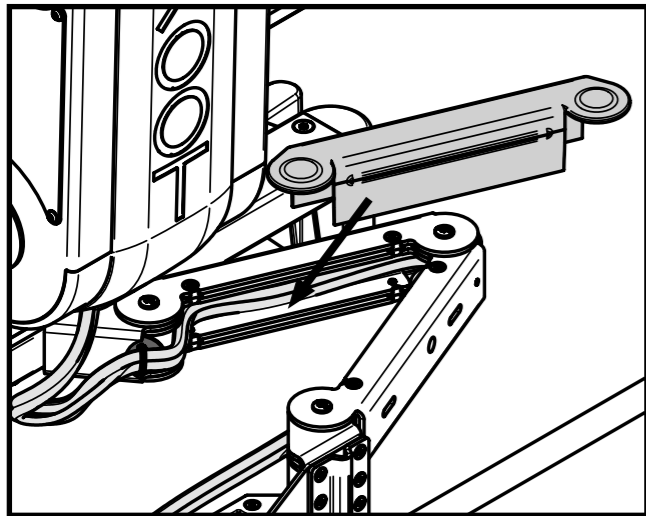
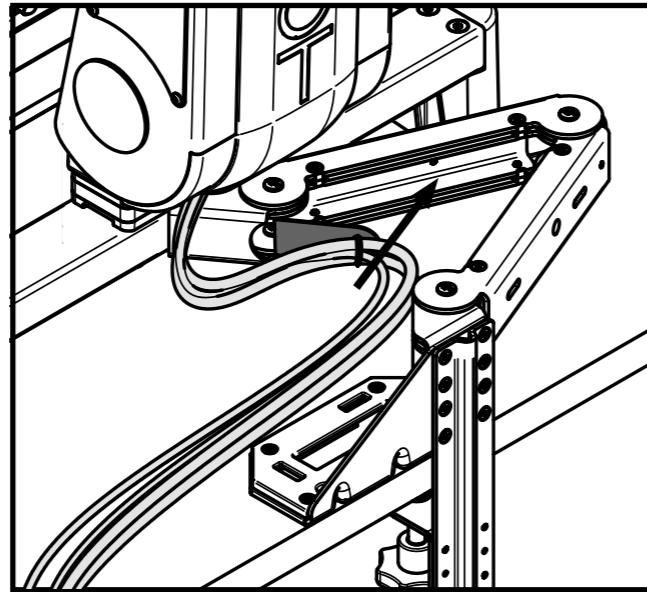
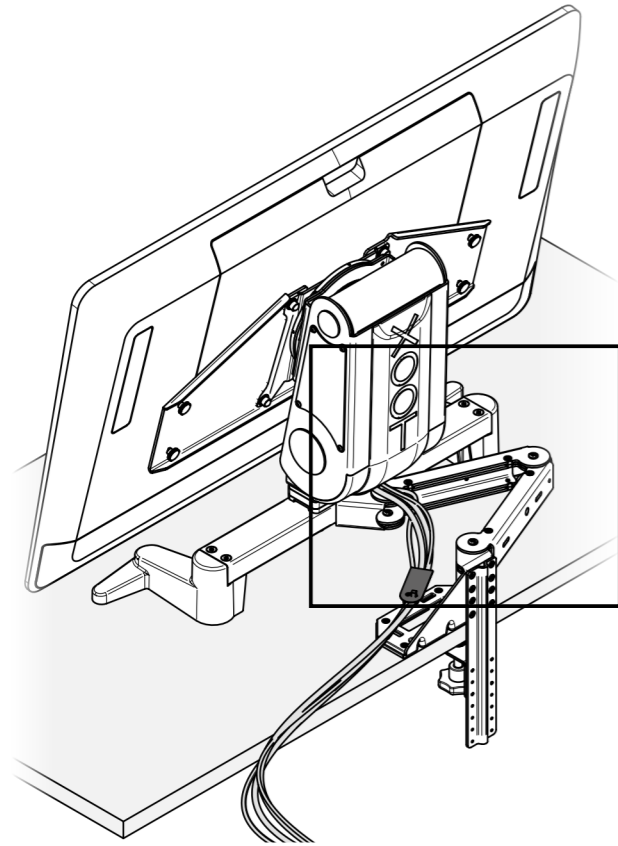

I Attaching the Touch Strips to Your Screen

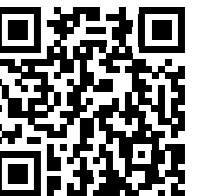
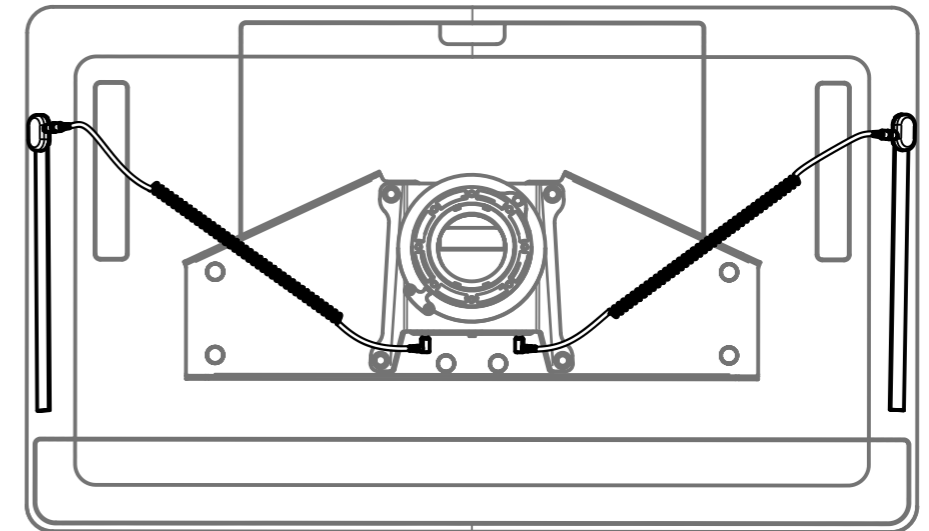
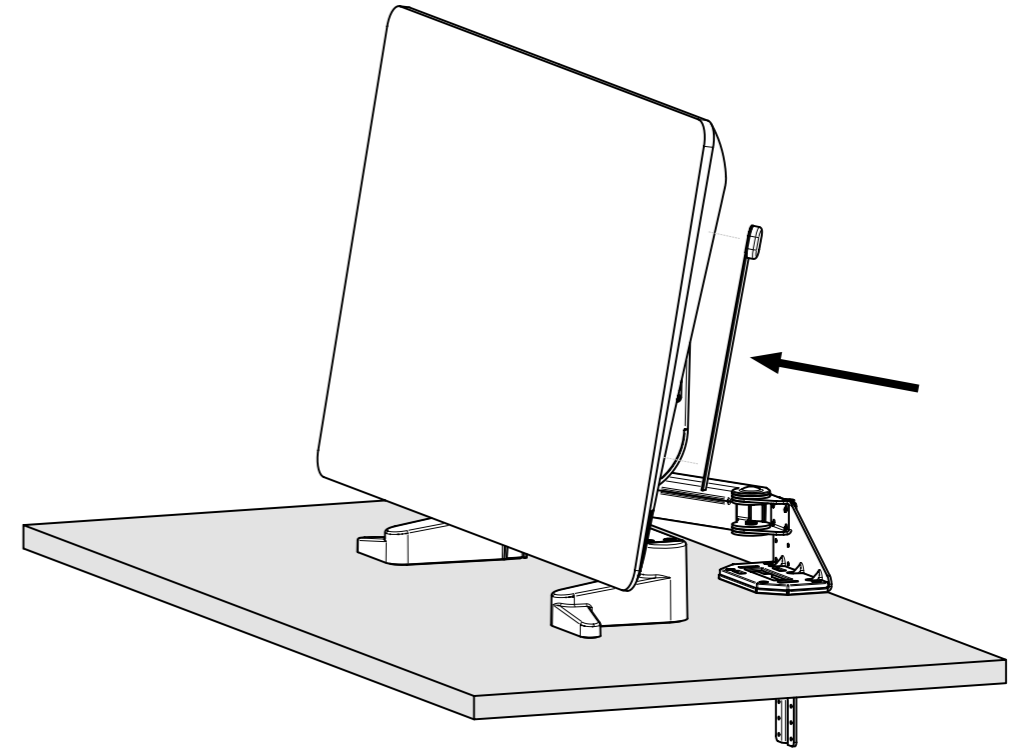

J Adjusting the Rotation Friction

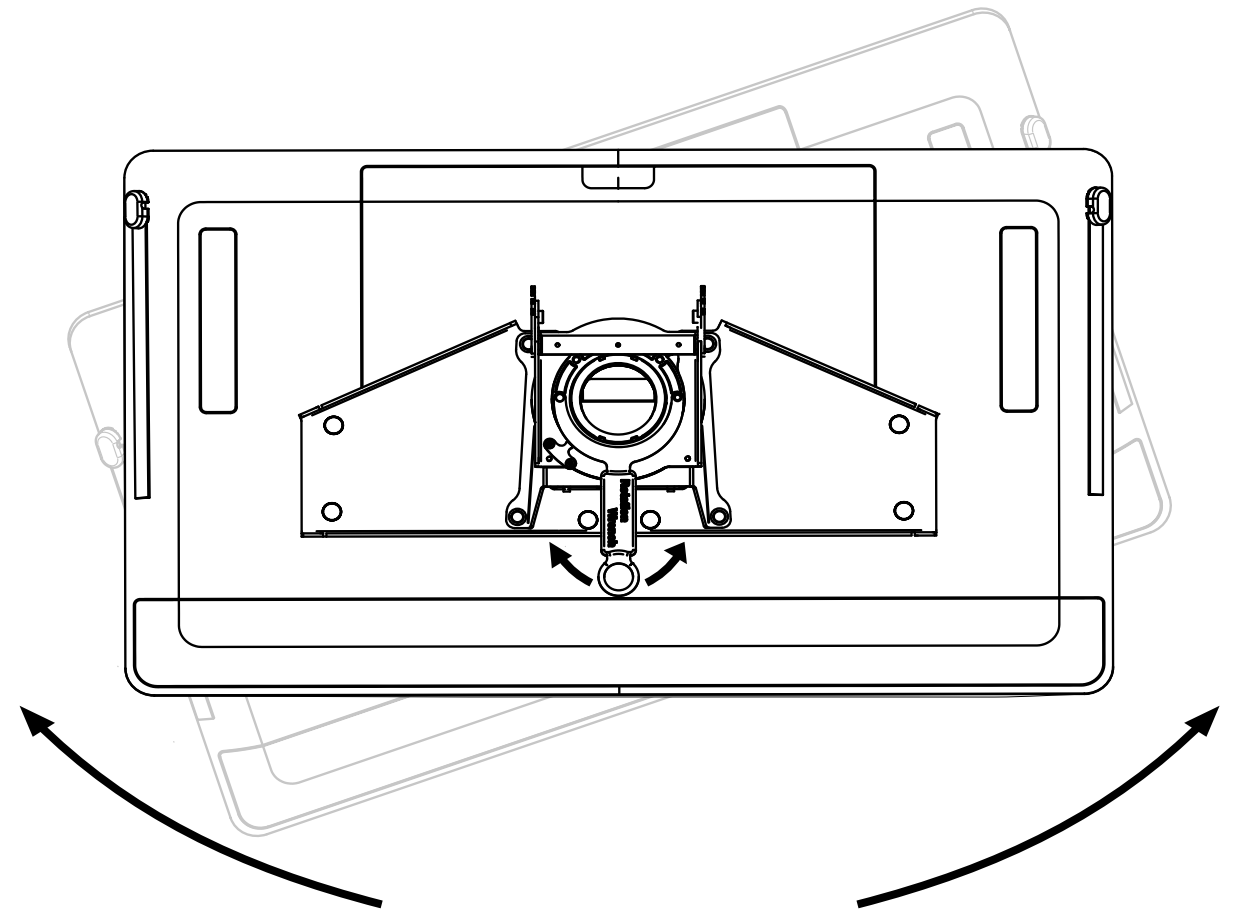
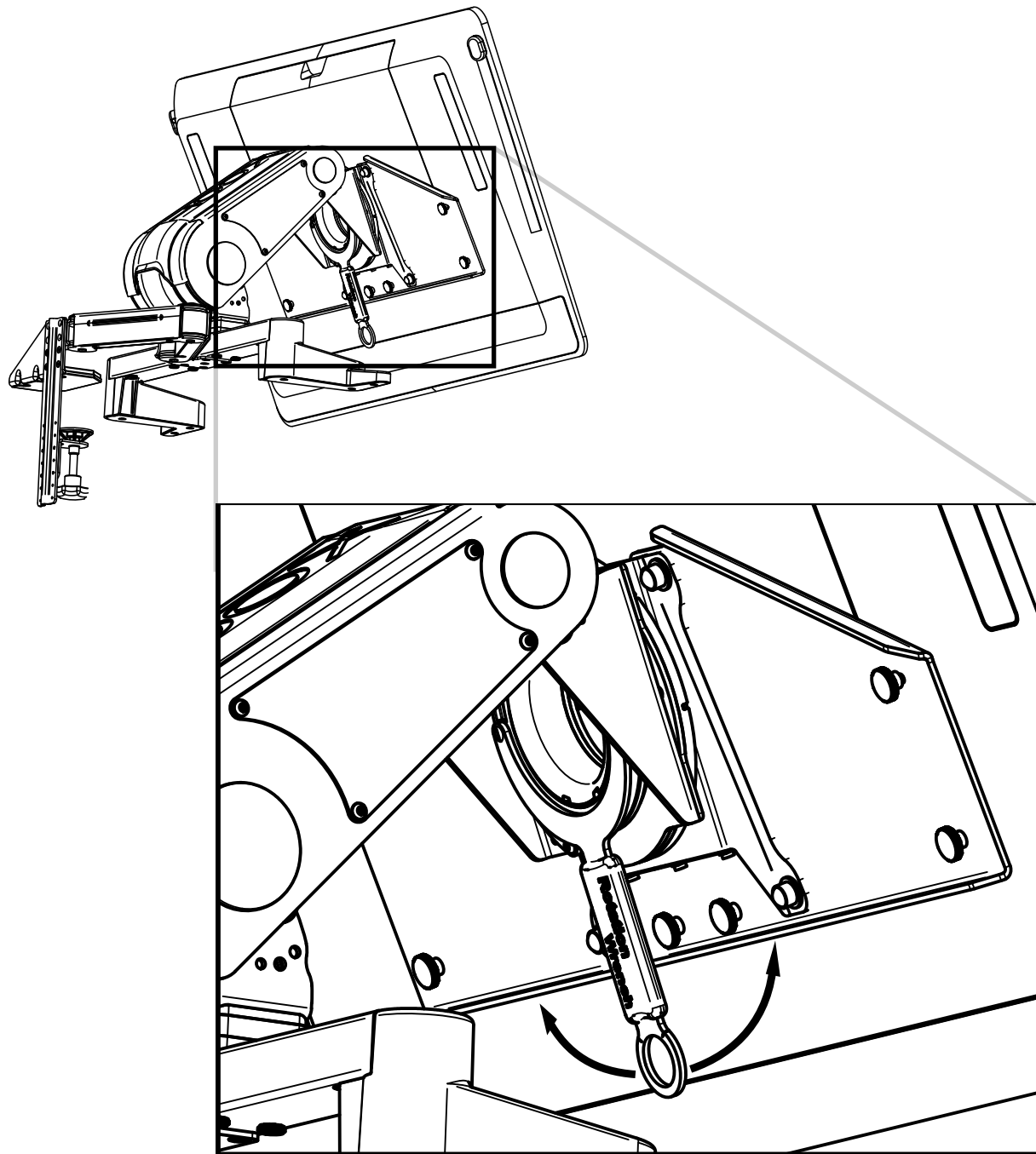

Loosening with wrench will decrease friction of display rotation.

* Loosening too much will cause the display to wobble.

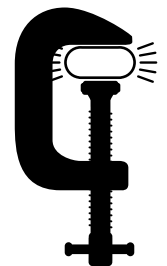

Tightening with wrench will increase friction of display rotation.



K Attaching the Folding Feet to Screen *(Optional)*

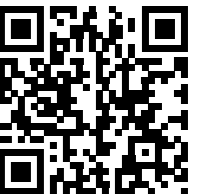
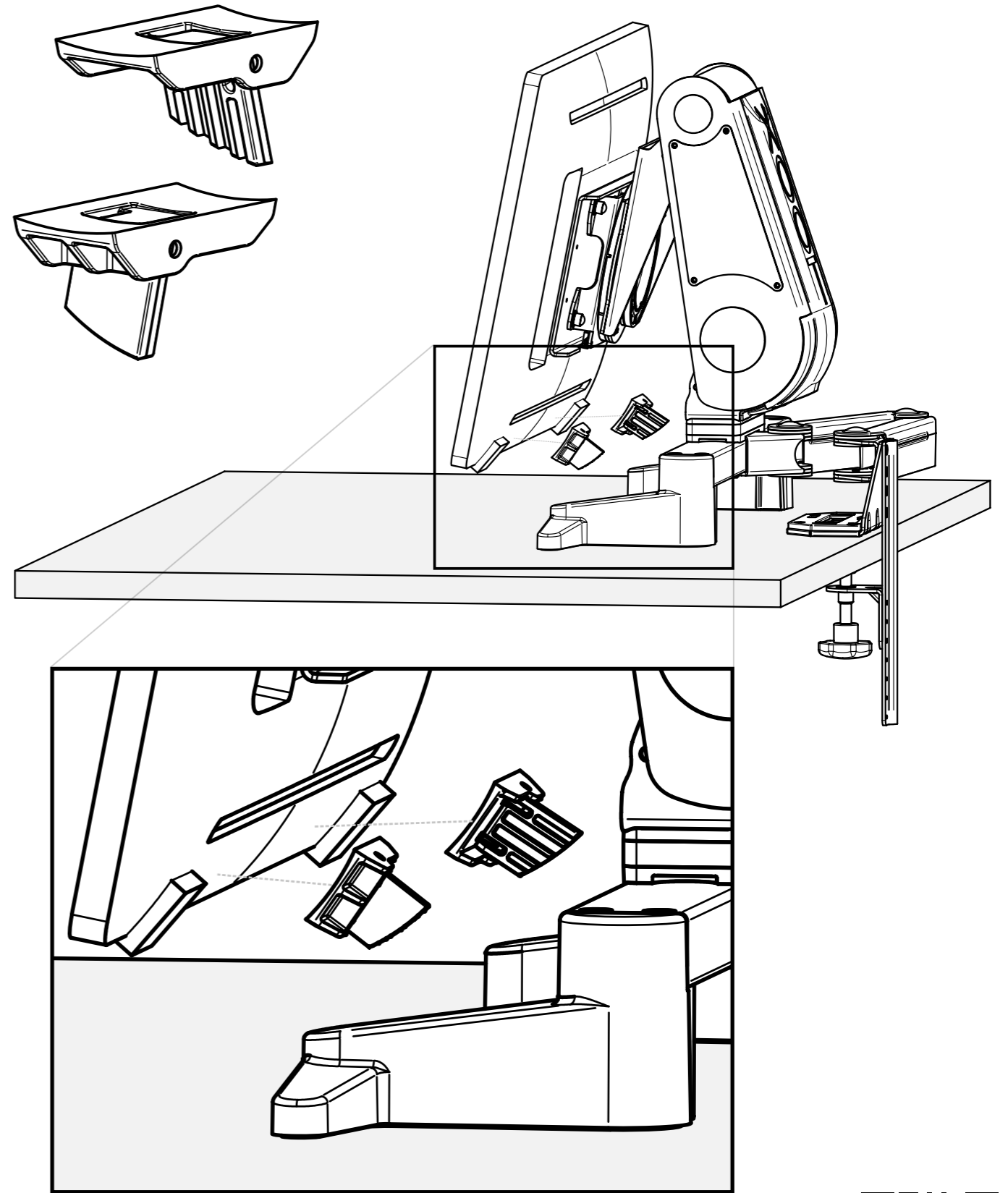
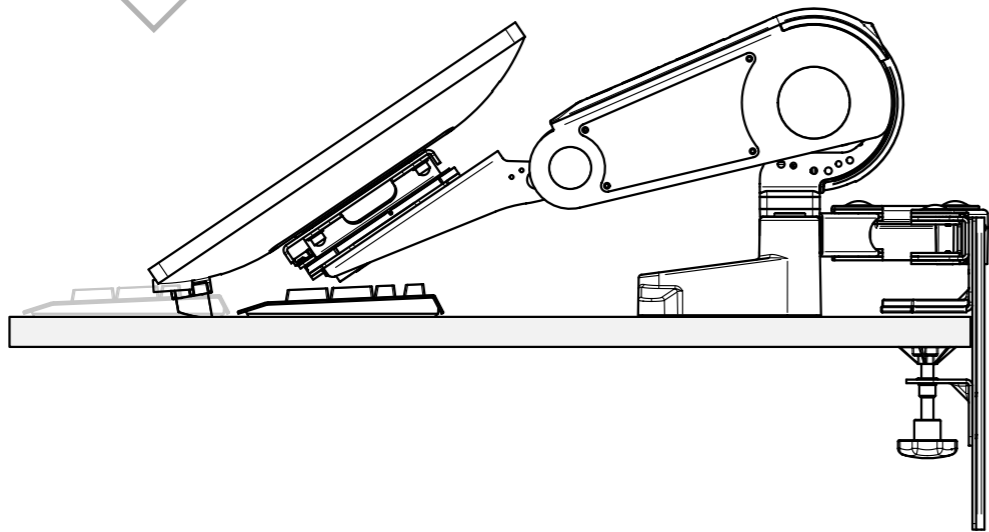
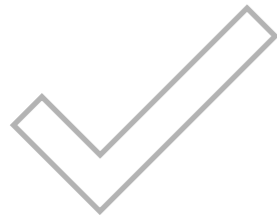
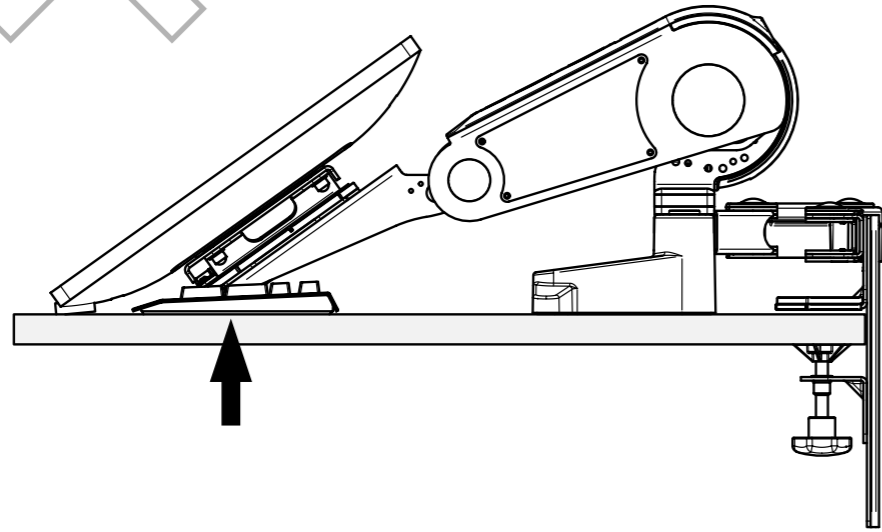
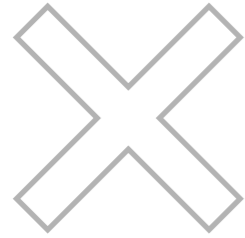

L Attaching the Screen to a MT11 Kit or CP27 Kit

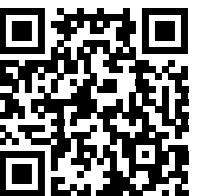
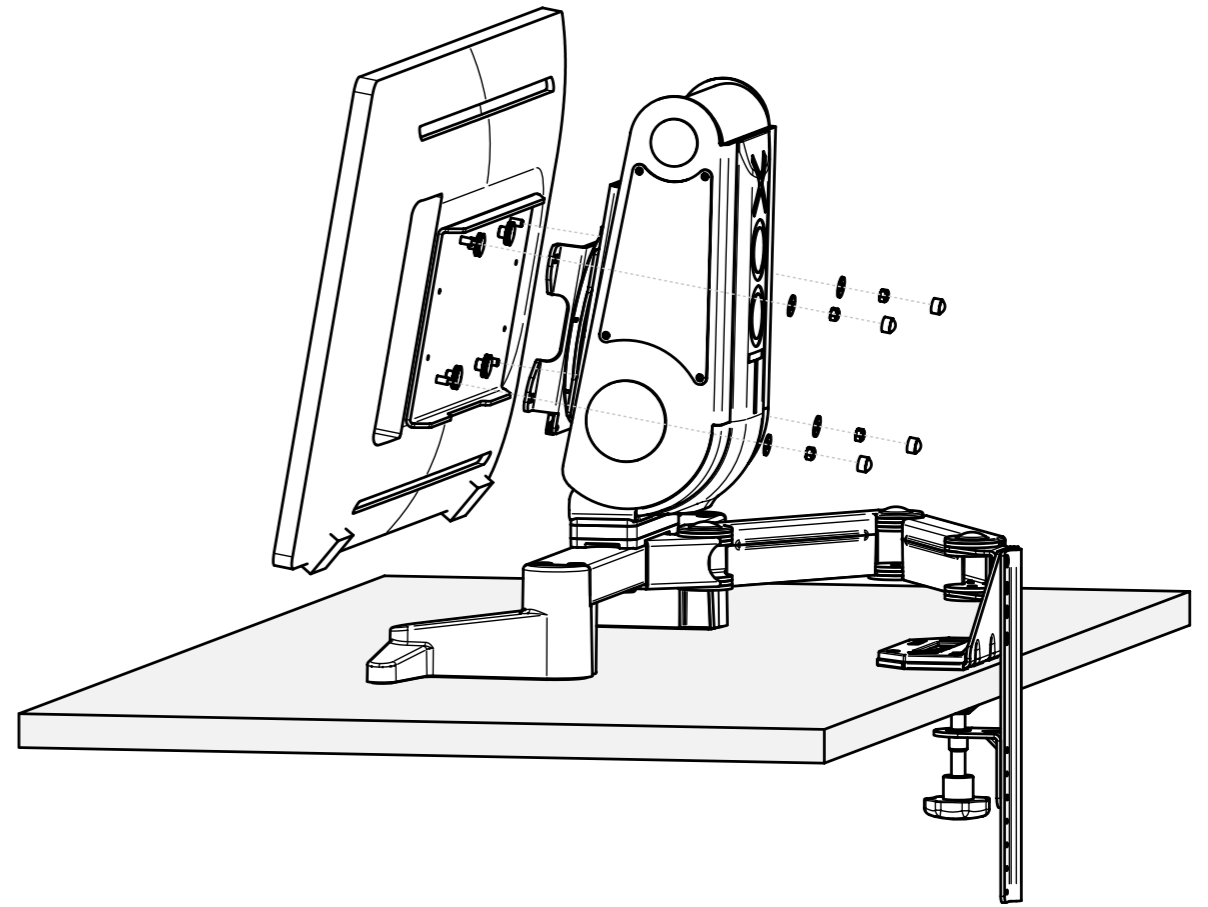
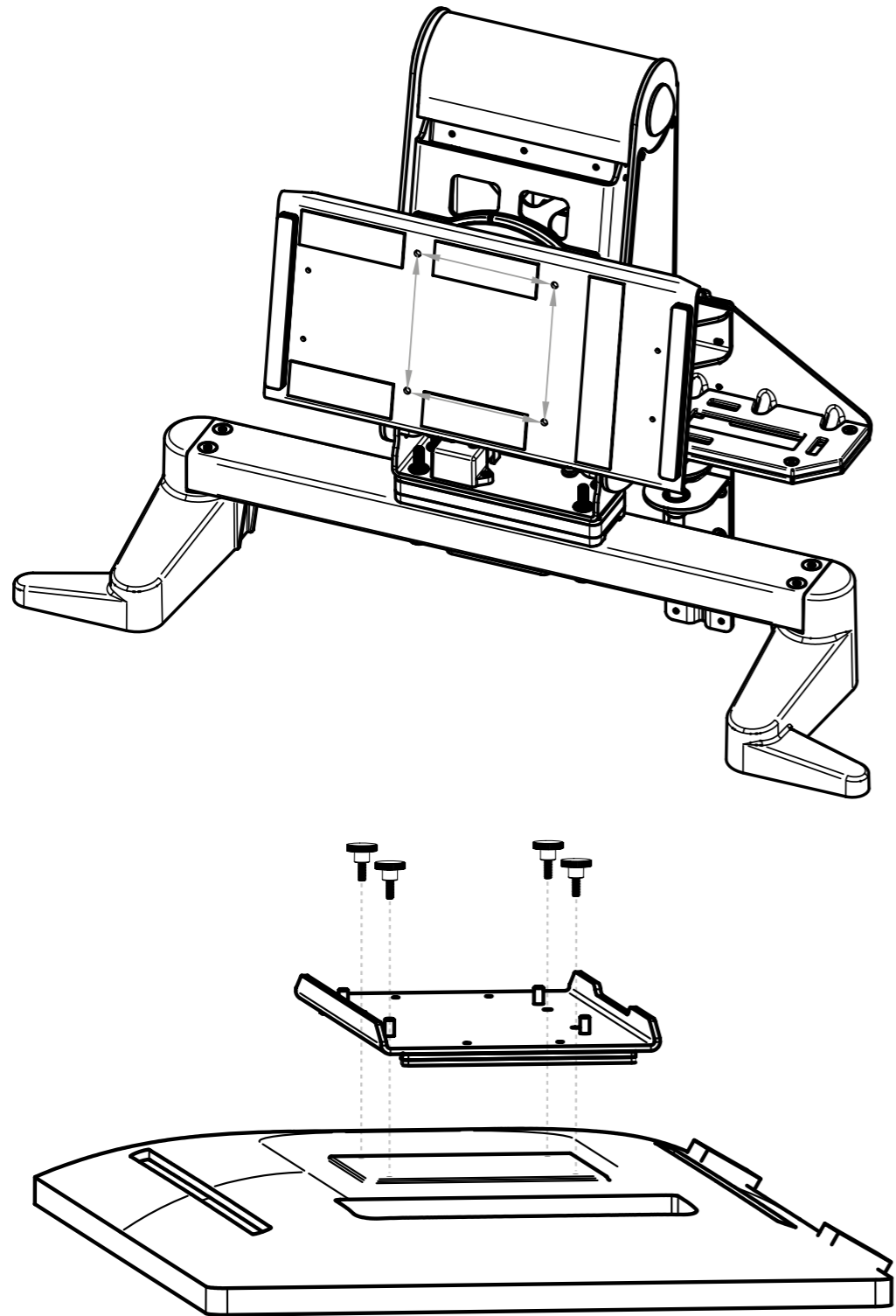

M Attaching Pre-Stress Pads to an MT11 Kit *(Optional)*

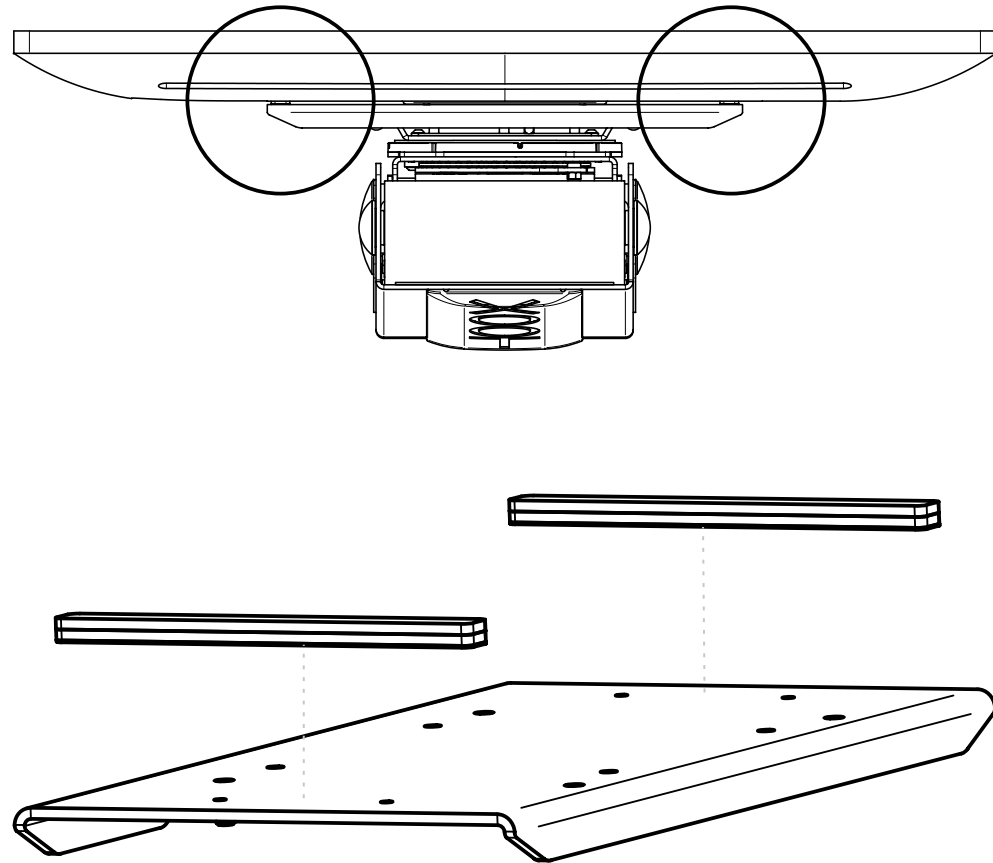



Some displays may not have a flat backside.

Pre-Stress pads can be used to ensure good contact with the full MT11 mounting plate. This should reduce display wobble.

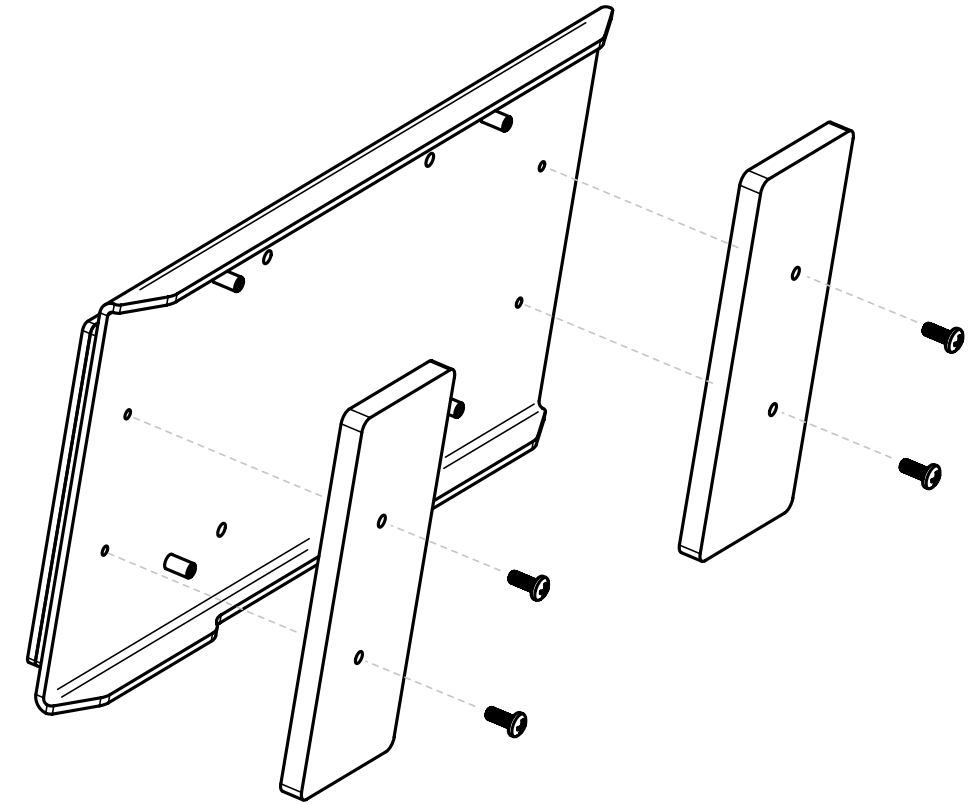

N Attaching Weights to MT11 Kit *(Optional)*

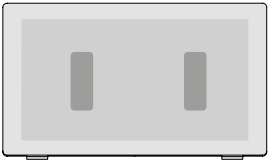
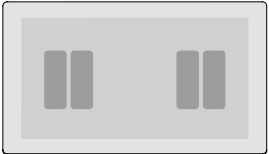

	Screen Weight	Weight to Add
	7-5kg (15-11lb)	0kg
	6-4kg (13-9lb)	1kg (1 x Kit)
	5-3kg (11-6.5lb)	2kg (2 x Kit)

O XOOT Warranty

Limited Warranty:

The limited warranty covers defects in material and workmanship in the XOOT_Pro product from the date of purchase and includes: limited warranty covers defects in material and workmanship in the XOOT_Pro product from the date of purchase and includes:

- 3-year limited warranty term on all cables and electrically powered parts.
- 5-year limited warranty term on all other parts.

How will XOOT correct a problem with my product?

XOOT will examine the product or submitted evidence and decide if it is covered under this limited warranty. If considered covered:

1. XOOT may send replacement parts.
2. If XOOT determines the product should be sent back, we will either repair the defective product or replace it with the same or comparable product.

If determined covered by this limited warranty, XOOT will pay the costs of repairs and spare parts. The replaced parts become the property of XOOT.

If XOOT no longer sells the item, XOOT will provide an appropriate replacement. It is XOOT that determines, at its sole discretion, what constitutes an appropriate replacement.

What is not covered under this limited warranty?

This limited warranty does not apply to products:

1. that have been stored, assembled, or installed incorrectly;
2. used inappropriately, abused, misused;
3. that have been repaired or modified in a way that XOOT deems inappropriate.

This limited warranty does not cover the following:

1. normal wear and tear;
2. cuts or scratches;
3. damage caused by impacts or accidents.

This limited warranty does not apply if the product has been placed outdoors or in a humid environment.

This limited warranty does not cover consequential or incidental damage. For customers in the US only: Some states do not allow the limitation or exclusion of incidental or consequential damage, so this limitation or exclusion may not apply to you.

P XOOT Returns

Return Policy:

If you are not satisfied with your purchase, you can return it within 30 calendar days from the date of purchase for a full refund. To be eligible for a return, your product must:

1. be in like-new condition;
2. include all manuals and accessories;
3. come in original packaging.

Please note that shipping and handling charges will be the customer's responsibility.

How to Return a Product:

To return a XOOT product, you must follow a few important steps:

1. Send an email to the following email address: support@xoot.pro
2. If the return is accepted, you will receive a RMA (return merchandise authorization).

The RMA will include further instructions on the steps for the return.

X
O
O

X O O T

O

O

T

XOOT Inc.

12311 SE 23rd Street
Bellevue WA 98005, USA
tel. 001 345 678 9123
info@xoot.pro | xoot.pro